

Artemide®

2020 ↗

Sustainable Innovation

Light led us to technological revolutions, by offering us the chance to create tangible innovation, driven by the unique union of scientific expertise, technical know-how and humanistic heritage.

Artemide declares, even more explicitly, its perspective towards the future: a value-driven approach to the project, guided not only by scientific research, technological and production expertise but also by a humanistic and ethical approach.

Artemide has embarked on a concrete path towards 360° sustainability, not only environmental but also social. Over the years, this commitment has led to obtaining many certifications such as **ISO 9001**, **ISO 14001** to which the **ISO 45001** certification was added in 2019.

Sustainability Report

Artemide testifies and measures through the Sustainability Report a constant path towards a conscious and attentive project to man and the planet to highlight all the values that guide its perspective to the future.

The Sustainability Report following the GRI - Global Reporting Initiative - guidelines and according to a core approach declares and certifies multiple KPIs (key performance indicators), numerical indicators and measurable objectives relating to:

- environmental performance
- corporate governance
- social sustainability

The Sustainability Report testifies a transparent approach, demonstrates how Artemide promotes actions at all levels for a better quality of our future.



United Nations Global Compact

In 2019 Artemide joined the United Nations Global Compact confirming the goal of promoting, together with its collaborators, a solid and sustainable development project on which to base the company's strategy and daily functioning.

Artemide is committed to following the 17 SDGs - Sustainable Development Goals - annually reporting the concrete results of their application.

The Global Compact requires companies and organizations that join it to share, support and apply fundamental principles relating to:

- human rights
- working standards
- environmental protection
- fight against corruption

They are universally shared principles, derived from the Universal Declaration of Human Rights, the ILO Declaration, the Rio Declaration and the United Nations Convention against Corruption.

Flexia

↪ Mario Cucinella

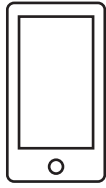

ARTEMIDE APP

Flexia stems from the combination of the technical lighting know-how of Artemide and the experience in sustainable design of Mario Cucinella, whose work pursues a constant focus on sustainable, conceived according to a holistic approach and laid out on all design scales.

They share a common vision aimed at improving the quality of everyday life while respecting people and the environment. Accordingly, attention to detail is coupled with simple principles, while respect for the well-being of those who actually use spaces becomes a key characteristic determined largely by the quality of light.

The acoustic panel section controls reverberation, absorbing the sound waves reflected in the environment, whilst the patented Discovery technology, the result of research by Ernesto Gismondi into the quality of the light that animates the transparent emitting surface, generates a diffused emission of light that is both even and comfortable.

Flexia's flexible wings are equipped with a rotation mechanism that goes from 0 to 30° and 60° meaning that the many possible inclinations and positions can help calibrate interaction with the environment; shape, materials and density are selected to work mainly on the frequencies of human speech; the result is beauty that derives from a parametric and functional intelligence.

The Discovery patented technology applied here in fact produces a diffused, uniform, comfortable emission that also respects UGR standards for use in work spaces in any installation position. It is a technical performance expressed

through emotional perception and the magical quality of transparency, expressing Artemide's ability to look beyond traditional concepts and interpret technology in a way that is beneficial to our well-being.

Flexia develops through the visual space in a game of optical perceptions: when switched off, the lamp is ethereal and invisible; on, it becomes material, transforming into a solid made of light.

Flexia shows how the sustainability of a building can also be achieved starting from the very elements that animate the spaces; it has a reduced energy footprint, in fact, high efficiency and flexible control for environmentally-friendly use thanks to the possibility of controlling the emission with the Artemide App which produces environmental quality and encourages users to adopt increasingly conscious use of light.

This goes hand-in-hand with a careful choice of materials; in particular, the sound-absorbent part is developed using recycled fibres: the external fabric comes 100% from PET bottles, whilst the internal panel is obtained from waste materials.

Flexia has been designed to improve the quality of the environments, generating an efficient combination for all lighting needs; its light, versatile design fits transversally into all contexts in which acoustic and visual well-being needs to be assured.

The juxtaposition of multiple modules can shape environments based on the principles of perfectly balanced light and sound.

Flexia

1265 x 900 x 50 mm

Total Power: 35W



Photo by Giovanni De Sandre



“Flexia is a play on perceptions between the visible which is material and colour and the invisible which becomes light.”

Mario Cucinella

Flexia Wall
900 x 900 x 380 mm
Total Power: 35W

- Green
- Dark Green
- Olive
- Blue
- Orange



El Porís

↪ Herzog & de Meuron

El Porís
ø 1200 x 1470
12 E27 bulbs

● Matt Black

El Porís is a modern, light, rigorous chandelier, yet one that is also truly spectacular and sculptural. It is a large elementary, geometric structure that features light bulbs housed in traditional E27 attachments, leaving complete freedom of choice as to what sources to use. Three calendared steel tubes of decreasing diameter are united by four vertical mounts. The simplicity is immediately apparent, revealing design and production know-how that can solve the complexity in elements and details that disappear into the main structure.



"El Porís light is pleasant, bright enough, and still intimate, casting a shadow – as if it were a line drawing - on the wall."

Herzog & de Meuron

Gople System ↪ BIG

PATENT OF
INVENTION



ARTEMIDE
APP

"The new Gople System follows the success of our original Gople pendant lamps, extending the language of Alphabet of Light into new architectural typologies."

BIG

Gople track
1180 / 1772 / 3548 x Ø50 mm

- Black
- White

**Gople Spot
Track Medium**
150 x Ø77 mm
16° - 22° - 32°
Total Power: 25W

**Gople Spot
Suspension Medium**
150 x Ø77 mm
16° - 22° - 32°
Total Power: 25W

**Gople Spot
Track Small**
110 x Ø55 mm
13° - 20° - 28°
Total Power: 10W

**Gople Spot
Suspension Small**
110 x Ø55 mm
13° - 20° - 28°
Total Power: 10W

Universal Track
Gople Track is designed to allow double emission of both direct and indirect light.
A dedicated track that hosts different and mixed light performances including diffused and spot emission both upwards and downwards.

This is an increasingly universal language that diversifies its performance and expands the freedom to illuminate every surface and space.

Gople Track is available in different lengths of 48V modules that can be combined together. Thanks to Artemide's experience in developing systems that are increasingly unhindered by the limitations of electrical connections, Gople track can extend for long sections with just a single point of electrical connection.

A flexible wire connection between modules allows the freedom to follow the space and define any geometry. Furthermore this unconstrained joint is exceptionally innovative as it carries both power and signal, while being Artemide App and DALI compatible.

Gople Spot
The spot light performance can be achieved with Gople Spot, the latest addition to the Gople family, which offers highly professional performance within the soft geometries of its reduced-scale diffuser.

It can be used for the projection of both direct and indirect light and also task light. In fact with the

pendant version, Gople spot can be used to enlight your personal work space.
The spotlight comes in two sizes, corresponding to different power and flux levels, each with multiple beam angles.

Gople Spot offers efficient performance, excellent colour rendering and numerous variables in terms of emission qualities such as colour temperature and beam angles, which make it a professional, technical product. Artemide's expertise in managing the different qualities of light is also expressed in the ability to personalise light emissions with custom solutions, selecting the parameters of colour rendering and spectrum quality dedicated to specific display situations.

Two Families for One System
Gople Track can be combined with Alphabet of Light, to create an universal lighting system able to meet the requirements of any space, but above all to define a new approach to lighting projects.

Light thus follows spaces and activities not just by tracing geometries that move fluidly in three directions, but also through an alternation of light and shadow, the choice of light emissions that are diversified and specialised.

Alphabet of Light is a versatile, multi-use project, perfect for illuminating any space, which in combination with Gople Track opens up new fields of application and increasingly becomes the ideal tool for retail spaces.

Endless Possibilities

Top View

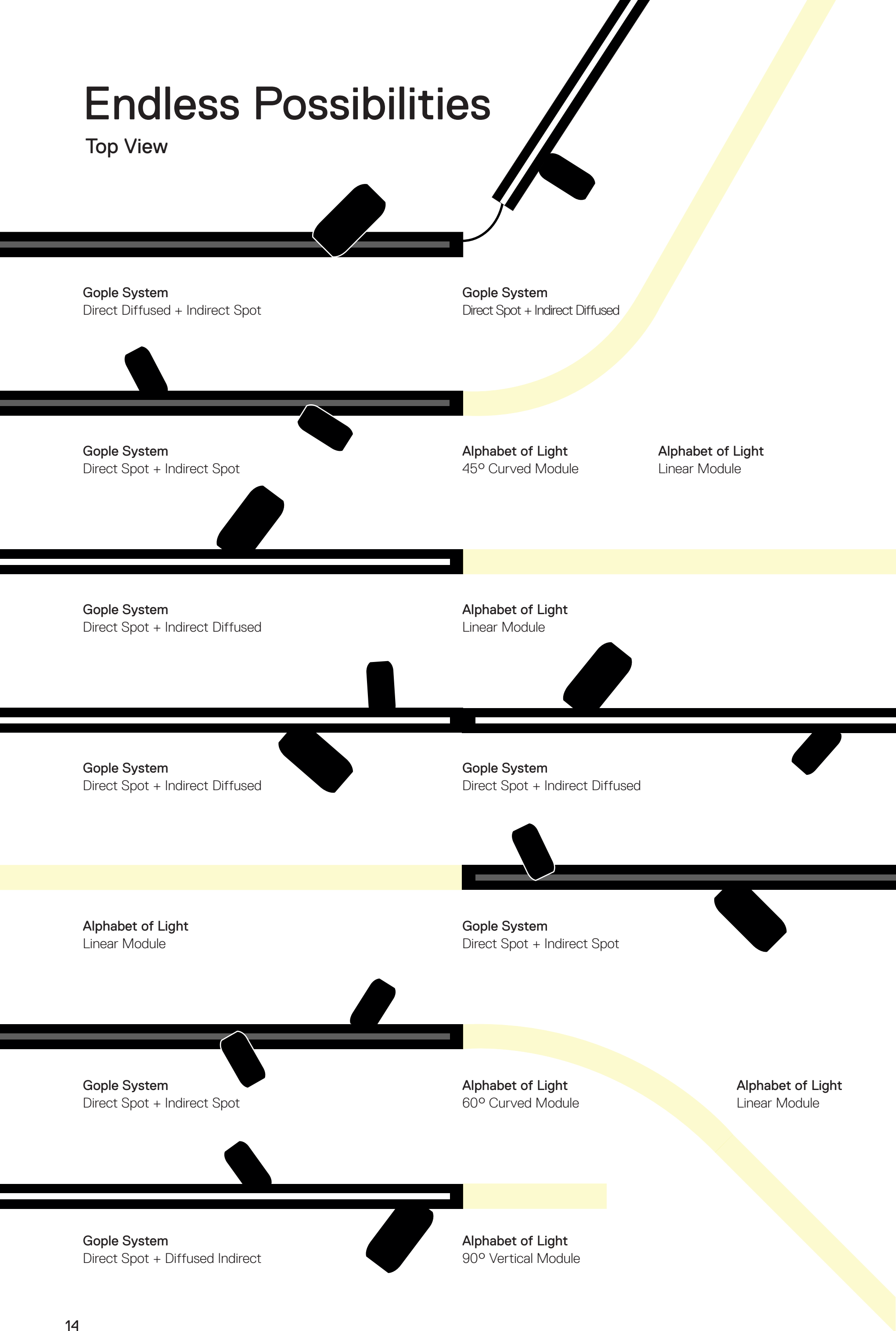

→ GOPLE SYSTEM



“Simplicity is at the heart of my philosophy when it comes to setting a table. This lamp isn’t a decorative element. Instead, it reveals its multiple functions through use: it creates an atmosphere, supports and enhances food and can be combined with various types of containers.”

Davide Oldani



Bontà

↪ Davide Oldani

Bontà
Ø120 x 268 mm
Total Power: 2,4W

Glass Diffuser
○ White

Glass Plates

● Grey
● Amber

● Red
● Aquamarine

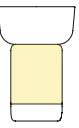

32h - 25%
0,6W

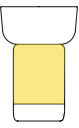

16h - 50%
1,2W

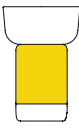

8h - 100%
2,4W

This new portable lamp explores the connection between light, food and conviviality. It's a portable lamp that interacts with objects on the table. "It reveals its secrets when you bring it to the table – you see the magic of this lamp when it combines with food." A body made from white milk glass diffuses the light, creating a relaxed atmosphere, while the upper recess is home to a glass bowl designed to hold food for sharing. This can be combined or alternated with a taller bowl and wider one – almost a plate – at the top. The bowls – and the lamp itself – are made from hand-worked glass, making them unique pieces whose texture, transparency and colour generate a special dialogue between

light and food, blurring the boundaries between them. Maximum attention to detail has been shown in order to do justice to the object itself and the other elements with which it interacts. Light plays a key role in creating the perfect atmosphere, interacting with other elements on the table and promoting sharing and conviviality. "It's not the lamp, but the light itself which accommodates the food and enhances it through the interaction it creates." Artemide's portable technology guarantees long battery life and represents the perfect solution for spaces where flexibility is required, such as in restaurants.



Gople Portable

↪ BIG



The Gople family keeps growing, with new versions dedicated to different lighting design languages. It now becomes a portable lamp that offers an impressive 32-hours of running time without mains electricity. Thus, everyone can be the architect of light in their own space, wherever it may be. Gople's characteristic diffuser is made of plastic in order to withstand use across a wide spectrum of spaces and situations. Inside, it allows just a glimpse of the hi-tech LED light source which also houses the batteries. Every element is designed to guarantee excellent light quality with high efficiency and low energy consumption.

Long running times unplugged from the mains (8-16-32 hours) go hand-in-hand with rapid recharging times. The soft, diffused light emission can be adjusted to 3 different brightness settings to create different ambiances. It is perfect for everyday lighting scenarios in personal spaces, but also for more social moments. Minimalist and simple in its elegant shape, it becomes an ideal, flexible element for lighting bars and restaurants, where it enables an unconstrained vision for lighting scenarios and ambiances that can change freely in line with organisation of spaces. Gople Plug is a simple more traditional version with a standard electrical connection.



32h - 25%
0,6W



16h - 50%
1,2W



8h - 100%
2,4W



Gople Portable
Ø130 x 267 mm
Total Power: 2,4W

○ White



Gople Plug
Ø130 x 267 mm
1 E14 bulb

○ White

PATENT OF
INVENTION

Discovery Floor ↪ Ernesto Gismondi



ARTEMIDE
APP

→ DISCOVERY FLOOR

Discovery Floor
400 x 1570 mm
Total Power: 55W

● Silver

● Black

● Bronze

RGBW

2700K

5700K





Nur Acoustic coloured ↪ Ernesto Gismondi

Nur Acoustic coloured
Ø 917 x 705 mm
Total Power: 80W

- White
- Blue
- Green
- Red

In 2016 the bestseller Nur, an iconic lamp from the Artemide collection, was restyled in a new acoustic version.

Today it is boosted with the addition of new colours thanks to innovation in felt pressing technology and a special paint finish which in no way detracts from the material's sound absorption properties.

The selected colours are all matched with a white inner surface to enhance light.

Nur Acoustic thus manages to create perfect ambient quality. The bell-shaped body is designed to interact not only through light, but also with ambient sound control.

The special material absorbs sound waves and reduces their reverberation time, while the geometry of the body enhances the material's properties by trapping and absorbing sound.

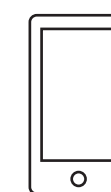

**ARTEMIDE
APP**

Gople Outdoor ↔ BIG

Starting from the iconic silhouette of the glass diffuser, Gople proposes new sizes and materials to create different ways of lighting spaces.

BIG designs a family of outdoor lights with the freedom and flexibility to suit any space, with an almost nomadic character. The diffuser, made in lightweight, durable plastic, is the central element of the project which combines with other elements to bring light into spaces, giving rise to four versions of Gople Outdoor.

It can be positioned freely or hung anywhere using a climbing rope.

It can be mounted on a pole, available in 3 different heights, for planting directly into the ground irrespective of the power supply, for which purpose a long cable with IP plug is supplied.

The different versions interpret a common approach to light that develops close interactions with activities and people. Gople outdoor can be moved around easily for different interpretations of spaces, catering to the changing requirements of outdoor living, with infinite possible interpretations of use in a constant stream of new situations. Enabling new ways of using light in outdoor spaces with the utmost freedom, Gople Outdoor can be reused and reinterpreted in multiple spaces and situations.

Its approach resembles that of a tool that can be moved around anywhere and at any time to suit needs.

Gople Outdoor Floor / Suspension

Ø 315 x 657 mm
1 x E27

○ White

Gople Outdoor Stem

1700 / 1225 / 750 x Ø 315 mm
1 x E27





→ GOPLE OUTDOOR

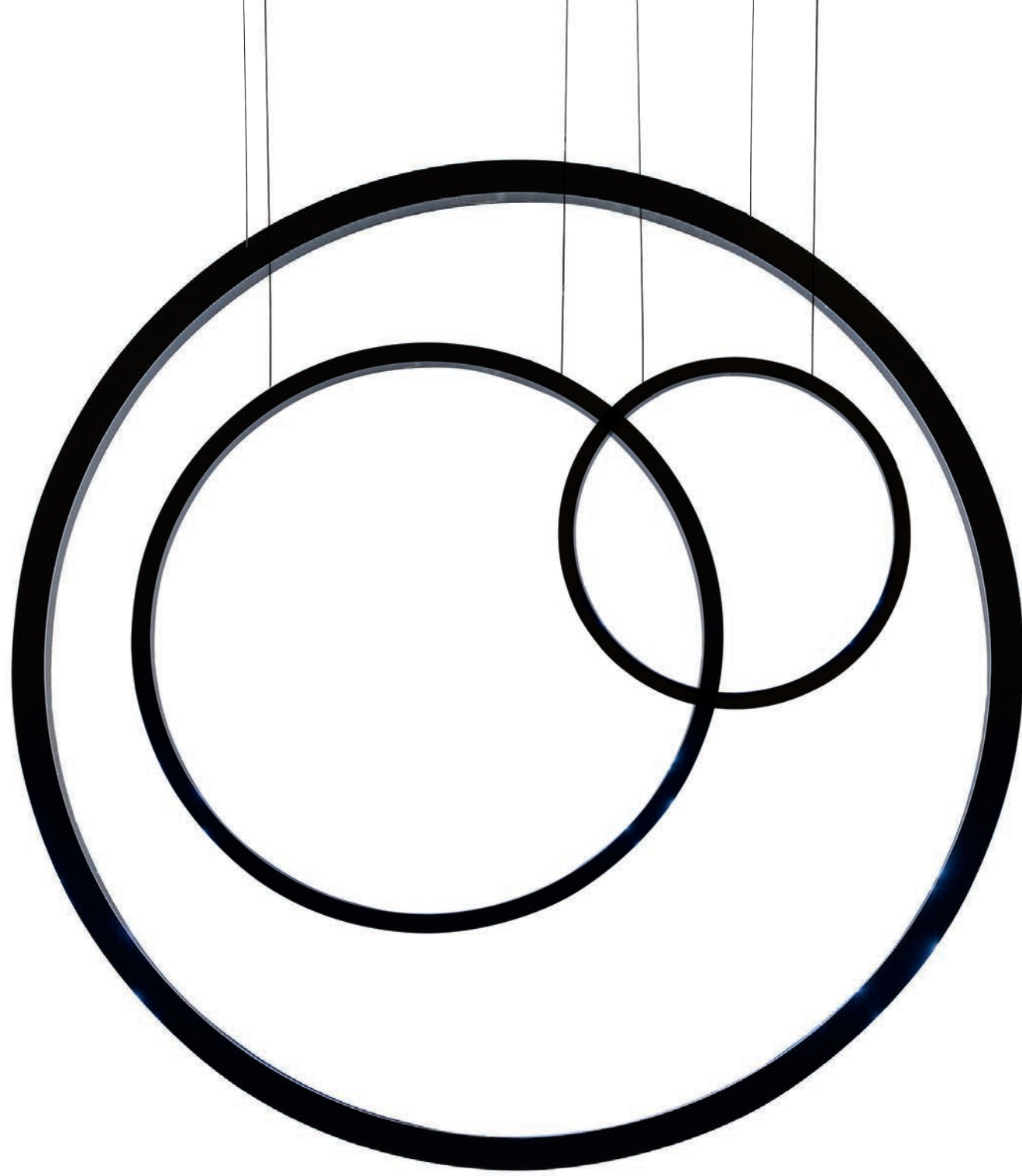

"O" 150

↪ Elemental

"O" 150 Floor
 Ø 1500 - base 700 x 200 mm
 Total Power: 70W

● Black

"O" 150 Suspension
 Ø 1500 mm
 Total Power: 70W

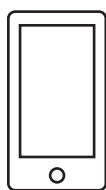

ARTEMIDE
APP

"O" is an essential element which, when switched off, frames nature and suggests perspectives, constituting an unobtrusive object in space that in no way alters the existing balance.

Its controlled and comfortable light emission can be adjusted with the Artemide App to ensure focused operation, thus preventing waste and respecting the circadian cycles of all animal and plant species.

Introduced in 2018 in the ground and suspended outdoor versions, today it is a perfect lighting appliance for indoor use too, thanks to a cabled option that allows easy relocation. In this case too, the IP protection grade remains suitable for outdoor use.

Its lightness is not just formal: its thin aluminium profile is an element in its own right, which can be moved wherever needed, allowing multiple uses and creating a pleasant ambiance anywhere with its soft, non-glaring light.

As well as the original 90-cm diameter version, "O" is developed in a smaller, 45-cm version and today also in a larger 150-cm model.

"O" is thus an increasingly comprehensive family of elements that can be used to create dynamic lightscapes.



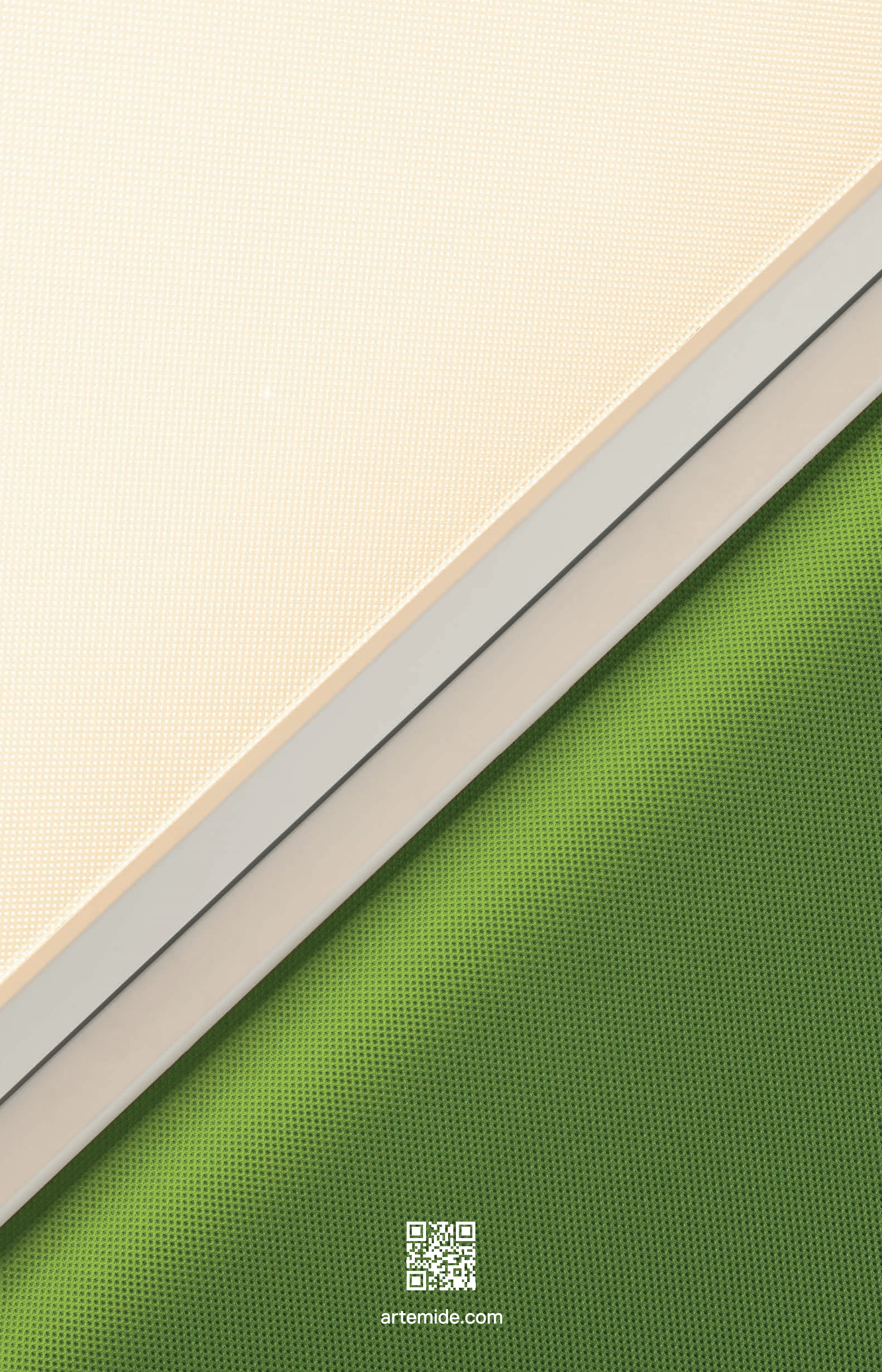

[artemide.com](https://www.artemide.com)